

NOTES:
 It is drawn to your attention that this drawing is a copyright work. The copyright is owned by the City of Bradford Metropolitan District Council and use of all or part of this work without the written permission of the City of Bradford Metropolitan District Council will be in breach of copyright. It is also drawn to your attention that the drawing(s) were drawn up for specific projects. Use of all or part of this drawing for any project other than that for which it has been specifically produced may result in an inappropriate drawing being used and could be dangerous/neglectful.

DO NOT SCALE FROM THIS DRAWING. Use figured dimensions only.

Notify Project Manager of any discrepancies.

This drawing is to be read in conjunction with all other contract documents and drawings.

This drawing is subject to confirmation by site survey.

All work to be in accordance with the current Building Regulations, current good practice & Construction, Design & Maintenance Regulations.

Revisions			
Rev	By	Description	Date
A	MJH	RIBA Stage 01 concept development	05/05/17
B	MJH	Approximate Position of Sub Station and Gas Meters added	22/05/17
C	MJH	Preliminary issue of Revit Model 01 to DT	16/06/17
D	MJH	Issue to Landscape Architect for sketch drawings	06/07/17
E	MJH	Incomplete drafts for school comment (ahead of 17th July meeting)	13/07/17
F	MJH	Option 1 colours for client approval	18/07/17
G	MJH	Option 2 colours for client approval	18/07/17
H	MJH	Preliminary issue of Revit Model 02 to DT	18/07/17
I	MJH	Issue to Landscape Architect for planning drawings	25/08/17
J	MJH	Preliminary issue of Revit Model 03 to DT	01/09/17
K	MJH	Preliminary issue to Tenos Fire Engineers	01/09/17
L	MJH	Interim issue to Client	04/09/17
M	MJH	Issue to Q.S. for cost estimate prior to planning submission	12/09/17
N	MJH	Issue to Landscape Architect prior to planning submission	20/09/17
O	MJH	Issue to Planning	06/10/17

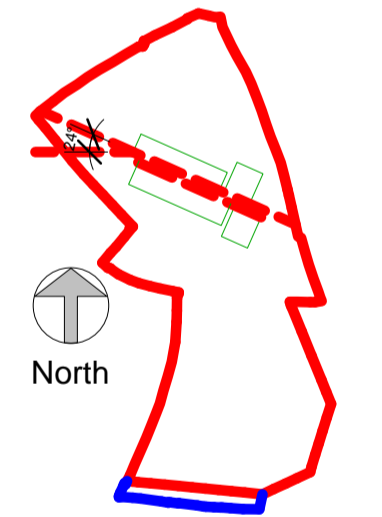

Key - Site Plan
 1 : 5000

City of Bradford Metropolitan District Council
 Department of Regeneration and Culture
 Economic Development and Property
Architectural Services
 Assistant Director: Mike Cowlam
 5th Floor-North, Jacobs Walk, Nelson Street, Bradford, BD1 5RW. Tel: (01274) 433842 Fax: (01274) 433893

CLIENT
 CBMDC Education Client Services

PROJECT
 Proposed Silsden Primary School

DRAWING
 RIBA Stage 02 - First Floor
 Plan Proposed

Architect/Lead	MJH	OS
Drawn	MJH	Date
Date	5th May 2017	Approved
Approved	BB	Scale: @A1
Scale: @A1	As indicated	
Drawing	A104	O

Preliminary - RIBA Stage 02

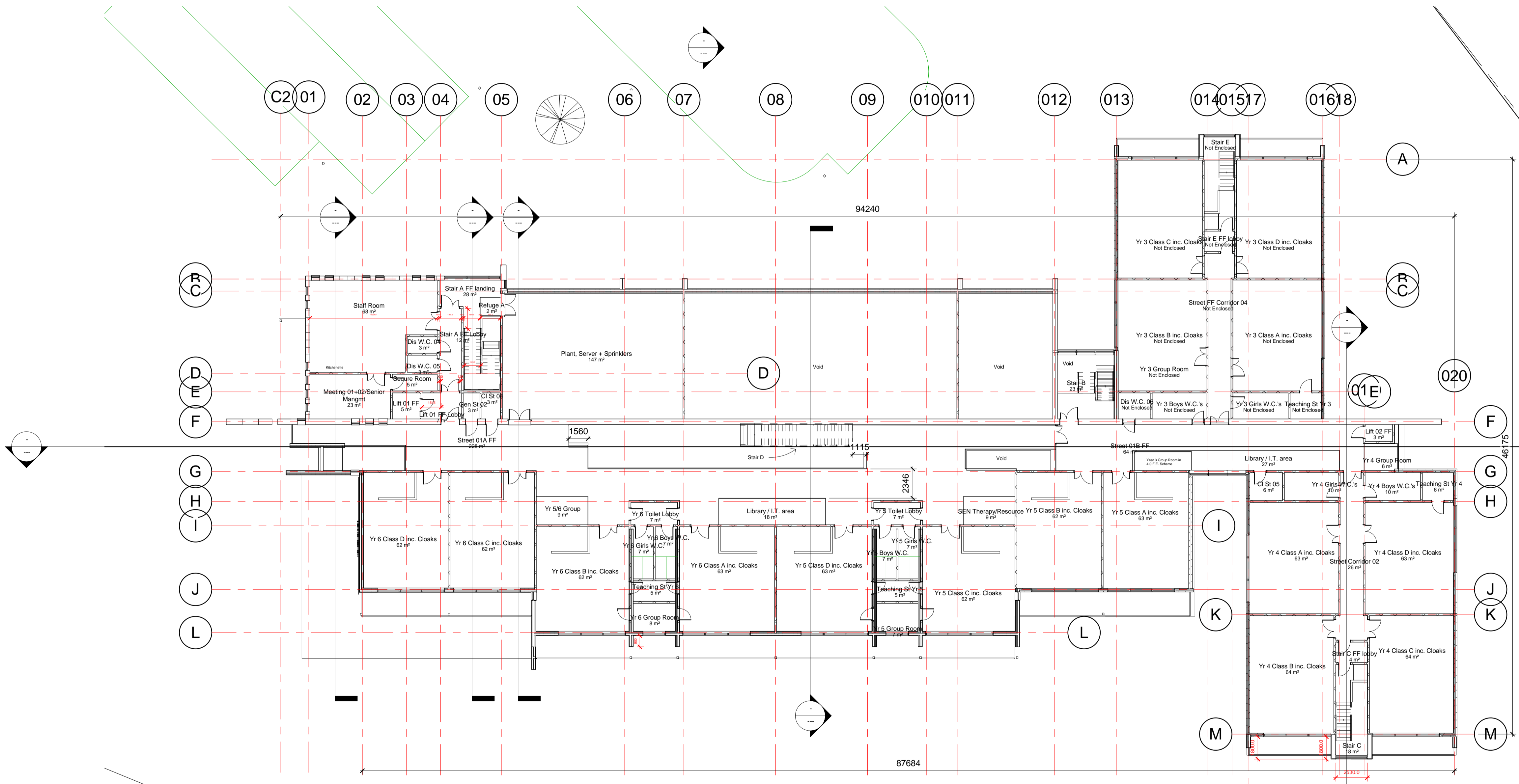

1 Plan 01 FF
 1 : 200